



INSTALLATION, OPERATION AND MAINTENANCE INSTRUCTIONS FOR INDEECO ARCHITECTURAL SLOPED TOP CONVECTOR "CASI" SERIES

1. Remove heater front panel and upper front grille for heater with front hot air exit to give access to junction box covers and fastening holes.
2. Remove the appropriate knock-out and run the electrical wiring through it.
3. Attach heater to the wall by using the 0.25 in. (6 mm) knock-out and the angle bracket.
4. Remove the junction box covers. Make connections according to local and national codes. See wiring diagrams.
5. Replace all covers before energizing.

HEATER INTERCONNECTION

The connection boxes and the wiring channel of this series heater and options are approved for interconnection of heaters and components which are on the same heating branch circuit. Grounding wire must join the ground lugs of all heaters.

For all other options of this series, use "EMT" or "BX" tubing to pass wires.

CONTROL OPTIONS

See instructions included with option.

ACCESSORIES

See instructions included with accessories.

BUILT-IN THERMOSTAT SETTING (option)

The built-in thermostat can be set with a small flat screwdriver through the upper grille.

To set the thermostat at the desired temperature:

- Set thermostat at maximum temperature (turn clockwise).
- When the desired temperature is reached, turn the thermostat counter-clockwise slowly until you hear a "click".
- The thermostat will keep this room temperature.

EMPTY CABINET INSTALLATION

Empty cabinets are installed the same way as complete heaters.

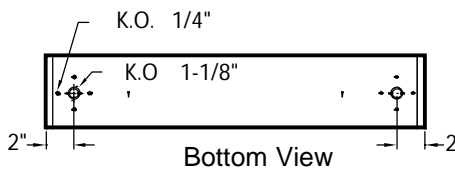
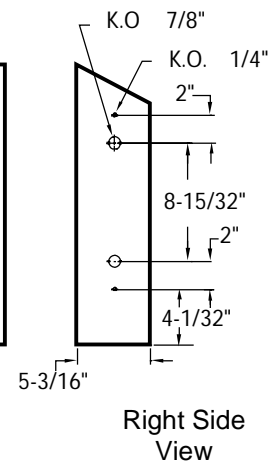
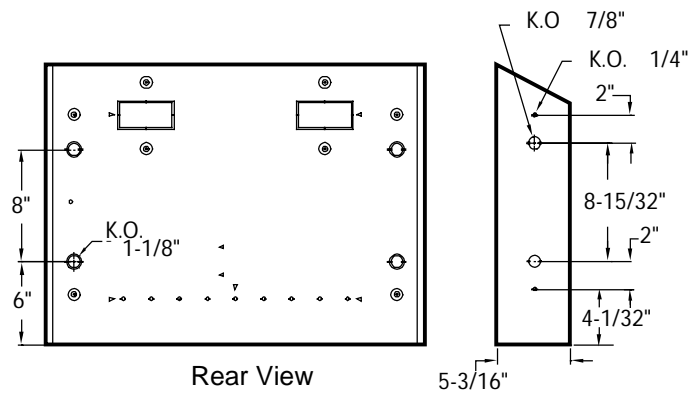
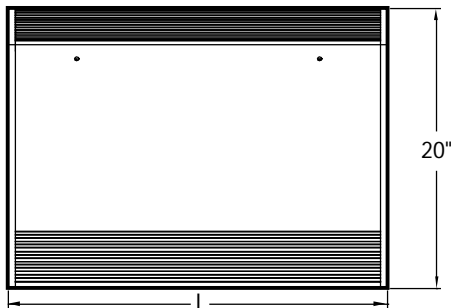

WATTS	LENGTH
2000	27"
3000	37"
4000	47"
5000	57"
6000	65"

425 Hanley Industrial Court • St. Louis, MO 63144
 Phone: (314) 644-4300 Fax: (314) 644-5332
www.indeeco.com